

Rainguard fitted in one piece along full body width behind top door seal against header as shown. Set height such that door seal passes just below flexible 'flipper' without catching/curling rubber under.

Ensure rainguard securely fitted using suitable stainless fasteners, max 5mm dia, along full width and suitable sealant bead of approx. 3 mm is included as shown in 'v' groove between rigid PVC carrier and face of header

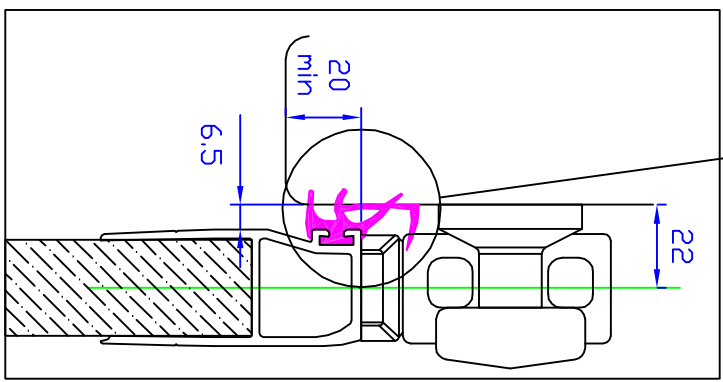

Fit door to give adequate overlap of the seals along the top and bottom of the door frame. Ensure that the door overlaps the frame by a minimum of 20mm, particularly at the top of the door. Allow extra for radii on frame members.

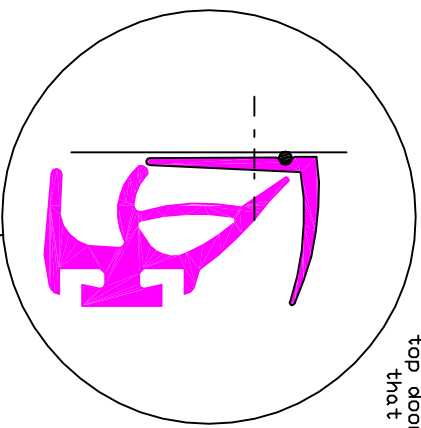
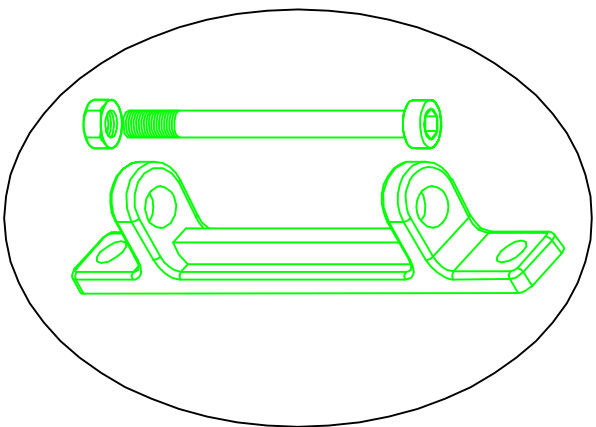

Ensure Nyloc nut is at lower end of hinge pin and is not over-tightened so as to distort hinge bracket and prevent dual acting hinge from operating correctly.

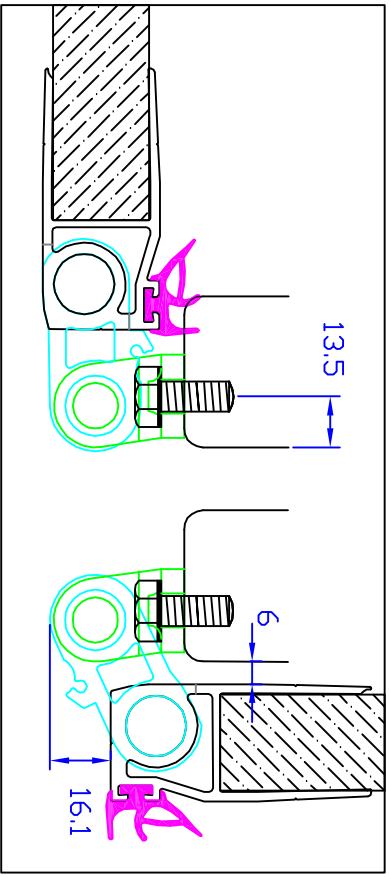

Section showing hinge arrangement in closed and 270° open positions. Fix brackets to pillar using M8 bolts of suitable length. Bracket is not symmetrical - ensure fitted in correct orientation, leaning outboard as shown.

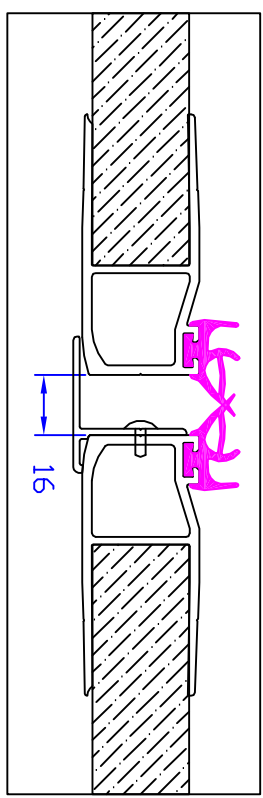

Ensure central gap between doors at meeting edge is correctly and consistently set.

NB Where centre seal 'T' section supplied loose (for deliveries outside mainland UK), ensure it is correctly fitted to required door using suitable rivets or screws through stem of 'T' into edge of door capping at approx. 500mm spacings or less

THIS DOCUMENT AND THE COPYRIGHT THEREOF ARE THE PROPERTY OF NORMANTON LAMINATING SERVICES LTD AND MAY NOT BE USED COPIED OR DISCLOSED TO ANY THIRD PARTY WITHOUT WRITTEN AUTHORIZATION.

Designed by **DNO** File name **Date** 23/06/05 Scale **NTS** Article No. ....

<p><b>NORMANTON</b> Specialist Panel Engineers</p>	<p>Normanton Laminating Services Ltd Lincoln Road, Airfield Industrial Estate, Pocklington YO42 1NR Tel: 01759 322160, Fax: 01759 322170 Website: www.normanton.co.uk email: sales@normanton.co.uk</p>			<p>Dwg. No. <b>SMOOTHLINER.3-FITTING.CONSIDERATIONS</b></p>	<p>Edition <b>A</b></p>	<p>Sheet <b>1/11</b></p>
	<p>Normanton Laminating Services Ltd Lincoln Road, Airfield Industrial Estate, Pocklington YO42 1NR Tel: 01759 322160, Fax: 01759 322170 Website: www.normanton.co.uk email: sales@normanton.co.uk</p>					